

RoboCupJunior Rescue Simulation (Demonstration) - Rules 2021 Draft 01



The RoboCupJunior Rescue Simulation (Demonstration) rules are developed and reviewed by the RoboCupJunior Rescue Technical Committee 2021. The simulation platform is developed and maintained by the Platform development team.

RoboCupJunior Rescue Technical Committee 2020

Chair	Kai Junge	UK
	Naomi Chikuma	Japan
	Tom Linnemann	Germany
	Ryo Unemoto	Japan
	Elizabeth Mabrey	USA
	Tatiana Pazelli	Brazil
	Alexis Cosette Arizaga	Mexico

Platform development team

Alfred Roberts	UK
Jeffrey Cheng	USA
Robbie Goldman	UK
Victor Hu	USA

RoboCupJunior General Chairs 2020

Trustees representing RoboCupJunior

Chair	Nerea de la Riva Iriepe	Sweden	Amy Eguchi	USA
	Julia Maurer	USA	Fernando Ribeiro	Portugal
	Shoko Niwa	Japan	Gerard Elias	Australia
			Gerald Steinbauer	Austria

Official Resources

RoboCupJunior Official Website	RoboCupJunior Official Forum	RCJ Rescue Community Website
 <p>https://junior.robocup.org</p>	 <p>https://junior.forum.robocup.org</p>	 <p>https://rescue.rcj.cloud</p>



Corrections and clarifications to the rules may be posted on the Forum in advance of updating this rule file. It is the responsibility of the teams to review the forum to have a complete vision of these rules.

Before you read the rules



Please read through the [RoboCupJunior General Rules](#) before proceeding on with these rules, as they are the premise for all rules. The English rules published by the RoboCupJunior Rescue Technical Committee are the only official rules for RoboCupJunior Rescue Simulation (Demonstration) 2021. The translated versions that can be published by each regional committee are only reference information for non-English speakers to better understand the rules. It is the responsibility of the teams to have read and understood the official rules.



Due to the Coronavirus pandemic, the 2021 competition will be virtual and will not be representative of the norm. Sections that apply to an in-person competition will be noted with a “(Not in 2021)” label. Sections that apply specifically for the 2021 competition will be noted with a “(For 2021 only)” label. ”



The "robot" refers "virtual robot" in these rules.

Scenario

For navigation of hard to dangerous or hard to access environments, robots can be used for search and rescue operations to minimize the risk to humans. In this challenge the autonomous controller for a robot must be developed to search and identify victims in a simulated hazardous rescue scenario. The robot must navigate through challenging terrains without getting stuck, must search for victims and signal the victims' locations alongside the map of the maze environment to human search teams.

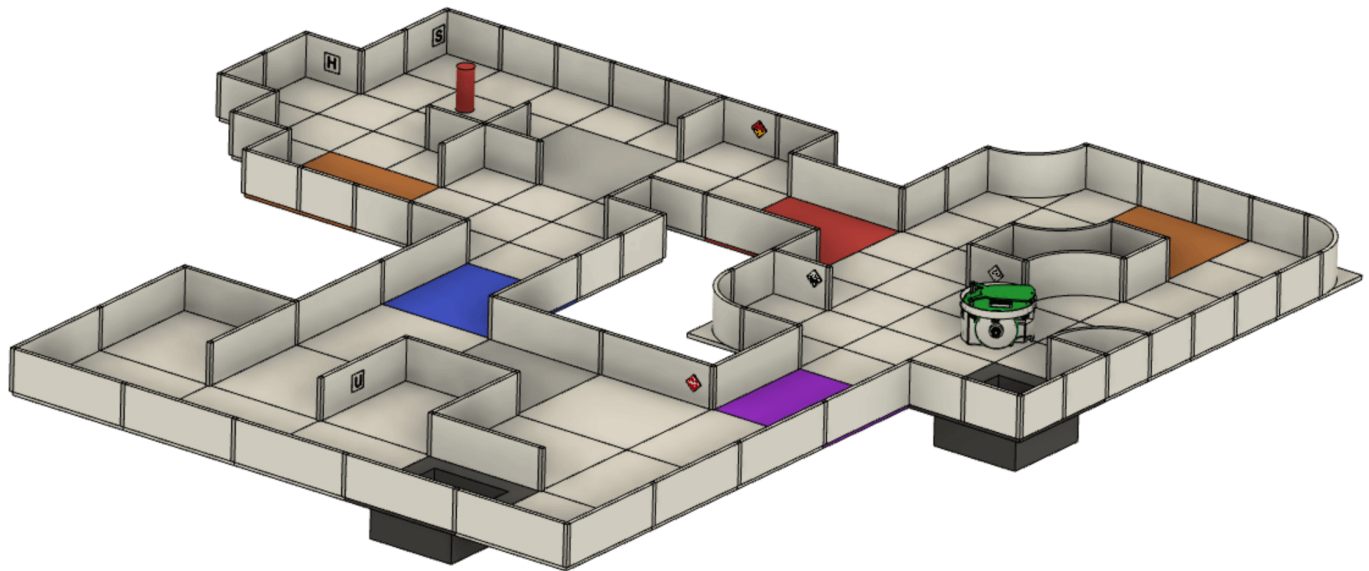

Summary

The robot needs to search through a maze for victims. The robot should not find the fastest path through the maze, instead it should explore as much of the maze as possible. The maze will be split into three distinct areas with different types of walls. The robot will be awarded 5 to 30 points depending on each victim detected. Points obtained in each area will be multiplied by a factor unique to each area.

If the robot is stuck in the maze it can be restarted at the last visited checkpoint. Silver tiles in the field represent checkpoints so the robot can save the position to a map (if it uses a map) in a non-volatile medium and restore it in case of a restart.

Contents

1. Code of Conduct	5
1.1. Spirit	5
1.2. Fair Play	5
1.3. Behavior	5
1.4. Mentors	5
1.5. Ethics and Integrity	6
1.6. Sharing	6
2. Field	6
2.1. Simulation platforms	6
2.2. Description	7
2.3. Checkpoints	7
2.4. Tiles, Areas, and Walls	7
2.5. Swamps, Obstacles, and Holes	8
2.6. Victims and Hazard Maps	9
3. Robots	10
3.1. Construction	10
3.2. Sensors	10
3.3. Control	11
3.4. Team	11
3.5. Inspection	11
3.6. Violations	12
4. Play	12
4.1. Pre-round Practice	12
4.2. Humans	12
4.3. Before the game	12
4.4. Start the game	13
4.5. Lack of progress	13
4.6. Scoring	13
4.7. End of Play	16
5. Open Technical Evaluation	16
5.1. Description	16
5.2. Evaluation Aspects	17
5.3. Sharing	17
6. Conflict Resolution	17
6.1. Referee and Referee Assistant	17
6.2. Rule Clarification	17
6.3. Special Circumstances	18

1. Code of Conduct

1.1. Spirit

1. It is expected that all participants (students and mentors alike) respect the aims and ideals of RoboCupJunior as set out in our mission statement.
2. The volunteers, referees and officials will act within the spirit of the event to ensure the competition is competitive, fair and, most importantly, fun.
3. **It is not whether you win or lose, but how much you learn that counts!**

1.2. Fair Play

1. Robots that cause deliberate or repeated damage to the field will be disqualified.
2. Humans that cause deliberate interference with the Rescue Simulation runs including simulation engine, server, and/or computers, will be disqualified.
3. It is expected that the aim of all teams is to participate fairly.

1.3. Behavior

1. Each team is responsible for verifying the latest version of the rules on the RoboCupJunior Official website, and additional clarifications/corrections on the official forum made by the RoboCupJunior Rescue Technical Committee prior to the competition.
2. (Not in 2021) Participants should be mindful of other people and their robots when moving around the tournament venue.
3. (Not in 2021) Participants are not allowed to enter setup areas of other leagues or other teams, unless explicitly invited to do so by team members.
4. Teams will be responsible for checking updated information (schedules, meetings, announcements, etc.) during the event. Updated information will be provided on notice boards in the venue and (if possible) on the local competition website and/or the RoboCup or RoboCupJunior websites.
5. Participants and the companions who misbehave may be asked to leave the venue and risk being disqualified from the tournament.
6. These rules will be enforced equally to all participants at the discretion of the referees, officials, tournament organizers and local law enforcement authorities.
7. (Not in 2021) Teams are expected to be present at the venue early on the setup day as important activities will occur. These activities include, but are not limited to: registration, participation raffle, interviews, captains and mentor's meetings.

1.4. Mentors

1. (Not in 2021) Adults are not allowed in the student work area.

2. Mentors are not permitted to be directly involved in the programming before and during the competition.
3. Mentor interference with robots or referee decisions will result in a warning in the first instance. If this behavior recurs, the team could face a possible elimination from the tournament.
4. Robots have to be mainly student's own work. Any robot that appears to be identical to another robot may be prompted for re-inspection.

1.5. Ethics and Integrity

1. Fraud and misconduct are not condoned. Fraudulent acts may include the following:
 - a. Mentors working on the software or hardware of student's robot(s) during the competition.
 - b. More experienced/advanced groups of students may provide advice but should not do the work for other groups. Otherwise, the team risks being disqualified.
2. RoboCupJunior reserves the right to revoke an award if fraudulent behavior can be proven after the award ceremony takes place.
3. If it is evident that a mentor intentionally violates the code of conduct, and repeatedly modifies and works on the student's robot(s) during the competition, the mentor will be banned from future participation in RoboCupJunior competitions.
4. Teams that violate the code of conduct can be disqualified from the tournament. It is also possible to disqualify a single team member from further participation in the tournament.
5. In less severe cases of violations of the code of conduct, a team will be given a warning. In severe or repeated cases of violations of the code of conduct, a team can be disqualified immediately without warning.

1.6. Sharing

1. The spirit of world RoboCup competitions is that any technological and curricular developments should be shared with other participants after the tournament. This furthers the mission of RoboCupJunior as an educational initiative.
2. Any developments may be published on the RoboCupJunior website after the event.
3. Participants are strongly encouraged to ask questions to their fellow competitors to foster a culture of curiosity and exploration in the fields of science and technology.
4. The [RoboCupJunior Forum](#) should be used for general queries and discussions whereas the platform specific [Discord server](#) should be used for technical questions regarding the platform.

2. Field

2.1. Simulation platforms

1. We will be running games on a platform called [Webots](#). For the setup guide: [Platform wiki page](#)

(under construction).

2. Teams are required to create programs to solve maze tasks.
3. (Not in 2021) The organizers will run the games on a server-client model, and will prepare one RJ-45 socket for teams to connect to the game server. Teams must prepare a computer and an ethernet cable to run the prepared programs.
4. (Only in 2021) The organizers will collect all of the teams' simulation software before the competition in advance to be recorded. The recordings will be used as competition runs, and will be showcased during the competition.
5. Teams are encouraged to develop their own worlds, and upload these to the Forum to encourage sharing.

2.2. Description

1. The field layout will consist of a collection of tiles with a horizontal floor, a perimeter wall, and walls within the field.
2. The field may be divided in up to three distinct areas with different types of walls for the robot to navigate around.
3. All areas are connected to each other by a passage one standard tile in width. The floor of this passage will be marked by a color.

2.3. Checkpoints

1. Silver tiles in the field represent checkpoints.
2. Silver tiles will be placed randomly at the start of each game.

2.4. Tiles, Areas, and Walls

1. The field is divided into tiles that are 30cm by 30cm in dimension. The tiles are not physical structures but rather a concept of how the field is generated. For areas 2 and 3, quarter-tiles are considered where each tile is subdivided into four 15cm by 15cm squares.
2. Walls will have a thickness of 1cm and a height of 10cm.
3. One of the outermost tiles is the starting tile, where a robot should start the run.
4. Walls may or may not lead to the starting tile by following the left/right most wall consistently. Walls that lead to the starting tile are called "linear walls". The walls that do NOT lead to the starting tile are called "floating walls".

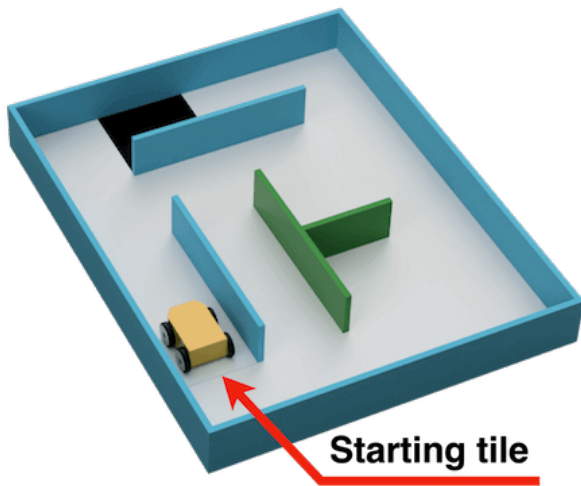

Linear walls



Floating walls

※The colour and walls configuration are for illustration only.

5. Pathways for the robot are intended to be of the width of the tile, and may open into foyers wider than the pathways.

- Area 1: Walls are placed on the edges of each tile.
- Area 2: Walls are placed on the edges of each quarter-tile. However, the robot's path must have at least a full tile worth of space.
- Area 3: Walls are placed on the edges of each quarter tile. However, the robot's path must have at least a full tile worth of space. Each 90 degree corner is rounded into a quarter circle.

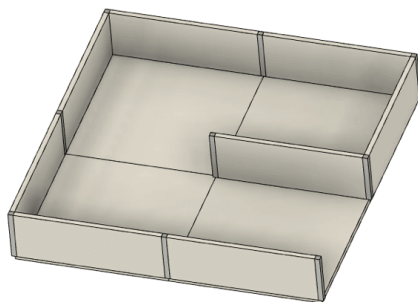

Area 1

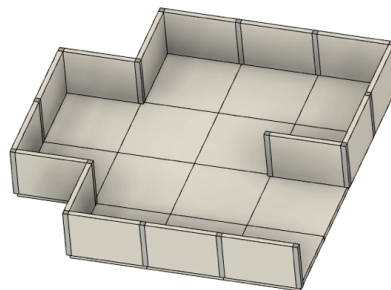

Area 2

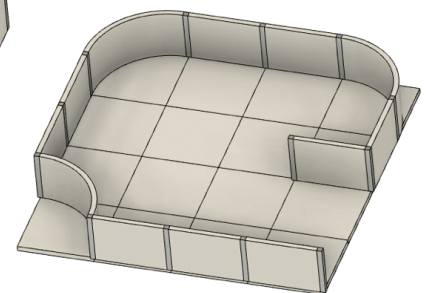

Area 3

6. Connection tiles between each area must have two sides surrounded by a wall, such that the tile has an unambiguous entrance and exit edge to the two areas.

7. The colours of the connection tiles are as such:

- Between area 1 and 2: Blue
- Between area 1 and 3: Purple
- Between area 2 and 3: Red

2.5. Swamps, Obstacles, and Holes

1. Swamps:

- a. The colour is brown.
 - b. Affects the straight-driveability and speed of the robot.
2. Obstacles:
- a. May be fixed to the floor.
 - b. May be any shape including rectangular, pyramidal, spherical or cylindrical.
 - c. The colour of the obstacle is not specified.
 - d. It must be at least 20cm away from every wall.
3. Holes:
- a. The edge of the holes is coloured black and will be 4cm from neighbouring tiles.
 - b. The robot has to avoid the hole.

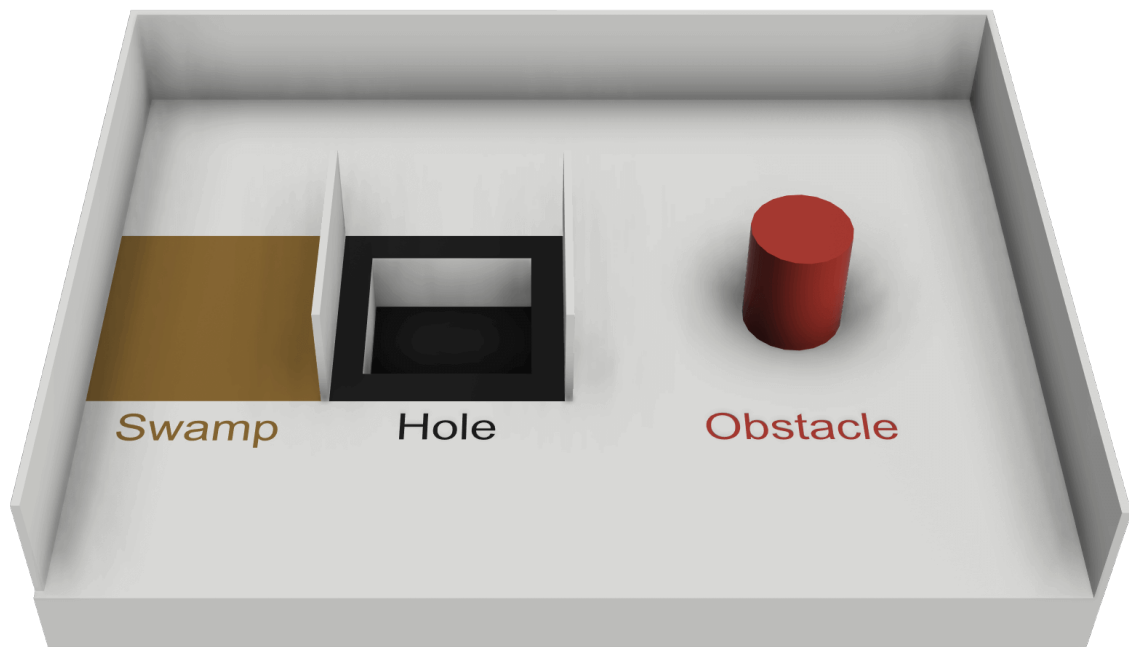

2.6. Victims and Hazard Maps

1. Victims and hazard maps are represented by a 4cm by 4cm image placed anywhere on walls (including curved surfaces)
2. Visual victims are uppercase letters printed on or attached to the wall. They are printed in black, using a sans serif typeface such as “Arial”. The letters represent the health status of the victim.
 - a. Harmed victim: H
 - b. Stable victim: S
 - c. Unharmed victim: U



3. Hazard maps are taken from the [RoboCup Rescue League website](https://www.roborescueleague.com/), out of which four will be used:

- Flammable Gas [F]
- Poison [P]
- Corrosive [C]
- Organic Peroxide [O]



3. Robots

3.1. Construction

1. The robot model used on each platform is provided by the organizers.
2. Teams are allowed to customise their robot (sensor locations, sensor types, wheel location, etc) using the provided robot customiser tool.

3.2. Sensors

1. The robot has the following sensors.
 - a. Location sensor to detect where the robot is in the field
 - b. Colour sensor to detect floor colour
 - c. Distance sensors to measure distance to surrounding walls
 - d. RGB camera to search victims and hazard maps
 - e. Lidar to measure the distance to surrounding walls
2. The simulation world and robot will have been created with noise which is similar to real world noise levels. Teams should ensure their programs are robust to this noise. The noise levels within the

simulation will not be changed for the competition.

3.3. Control

1. Robots must be controlled autonomously.
2. Robots will be started by the referee.
3. Robots may utilize various maze navigation algorithms. Any pre-mapped type of dead reckoning (movements predefined based on known locations or placement of features in the field) is prohibited.

3.4. Team

1. Each team must have between 2 and 4 members.
2. A student can be registered on only one team across all RoboCupJunior leagues/sub-leagues.
3. A team is only allowed to participate in one league/sub-league in across all RoboCupJunior leagues/sub-leagues.
4. Each team member will need to explain their work and should have a specific technical role.
5. All team members must be the correct age as stated on the [RoboCupJunior General Rules](#).
6. Mentors/parents are not allowed to work with or help the students during the competition. The students will have to self-govern themselves (without mentor's supervision or assistance) during the long stretch of hours at the competition.

3.5. Inspection

1. Students will be asked to explain the operation of their programs in order to verify that all are their own works.
2. Students will be asked about their preparation efforts and may be requested to answer surveys and participate in video-taped interviews for research purposes.
3. All teams must complete a web form prior to the competition to allow referees to better prepare for the interviews. Instructions on how to submit the form will be provided to the teams prior to the competition.
4. All teams must submit their source code accompanied by documentation and an engineering journal. All three documents will be shared online after the competition such that other teams can draw inspiration and learn from them.
5. The engineering journal – concise dated log shows your journey of the project. NOT meant to an after-thought document (a template will be provided)
6. The documentation - serves a summary of your project. This is an after-thought document to encapsulate your project as a whole (a template will be provided)

3.6. Violations

1. Modifications must be made within the time schedule of the tournament and teams cannot delay tournament play while making modifications.
2. No mentor assistance is allowed during the competition. (See [Section 1, “Code of Conduct”](#))
3. Any violations of the rules may be penalized by disqualification from the tournament or the round or may result in a loss of points at the discretion of the referees, officials, organizing committee or general chairs.

4. Play

4.1. Pre-round Practice

1. When possible, teams will have access to practice simulation environments for calibration and testing throughout the competition.
2. Whenever there are dedicated independent simulation environments for competition and practice, it is at the organizers’ discretion if testing is allowed on the competition environments.

4.2. Humans

1. (Not in 2021) Teams should designate one of their members as “captain” and another one as “co-captain.” Only these two team members will be allowed access to the competition areas where the simulation environments are located, unless otherwise directed by a referee.
2. All operations of the simulation environment in game, such as loading programs and operating LoP, are performed by the referee.
3. (Not in 2021) No one is allowed to touch the simulation environments intentionally during a game.

4.3. Before the game

1. (Not in 2021) When the beginning of a round is called, teams must submit their computer with the program to run saved on it. The method to collect the computers will be announced by the organisers.
2. (Not in 2021) The time limit of submitting the computer with the program to be run in each game will be decided by the organizers.
3. (Not in 2021) If the computer is not submitted by the time limit, the team is considered to have abandoned the game. The score of the game will be -50 points.
4. (Not in 2021) Competition World for each round will only be revealed after the round’s computers submission time expires.
5. (Not in 2021) No changes or updates to the program after the deadline of each rounds are allowed.
6. (Not in 2021) A game begins at the scheduled starting time whether or not the team is present or

ready. Start times will be posted around the venue.

7. Pre-mapping the field and/or victim's location is prohibited. Pre-mapping activities will result in immediate robot disqualification for the round.
8. (For 2021 only) Teams must submit the source code and any other required documents before a particular day set by the OC. Details will be shared through the Official RCJ Forum.

4.4. Start the game

1. (Not in 2021) Before the start of the game, the next team should prepare the computer submitted at the beginning of the round to run the program, as a client to the game server. A maximum of 2 minutes will be given.
2. (Not in 2021) When ready, run the program and report to the referee. The team is not allowed to touch a client computer after this in any reasons.
3. (Not in 2021) The game will start with a referee's operation on game server.
4. Each game time will be last between 4 to 8 minutes depending on the field. The field designer will decide this duration.
5. A "visited tile" means that center of the robot is inside. This judgement is made by the game management system.
6. (For 2021 only) Judges will start the game with the submitted code loaded on the simulation platform.

4.5. Lack of progress

1. A Lack of Progress (LoP) occurs when:
 - a. The robot has fallen into a hole.
 - b. Robot being in a static location for 20 seconds or more (automatically called).
 - c. (Not in 2021) In any other cases, calling for LOP rests on team captain, but final decision must be made by referee.
 - d. The referee determines the robot is not completely static but is stuck in sequence of motion. There will be a button to allow referee to execute a manual lack of progress.
 - e. The robot autonomously calls for a LoP.
2. In the event of a lack of progress, the robot must return to the last visited checkpoint (or the start tile if never reached a checkpoint). The robot can be installed in any direction. For the definition of the visited tile (see [4.4.5](#)).
3. When a LOP is triggered, the engine will send a letter "L" to the robot.

4.6. Scoring

1. To identify a victim, the robot must stop by the victim and blink an indicator light/LED for 1 second. After 1 second, it must send a command to the game manager with the type of the victim in a

platform specific format.

2. For successful victim identification, the center of robot must be equal to or less than half a tile distance from the location of the victim, when the robot indicates a victim has been identified.

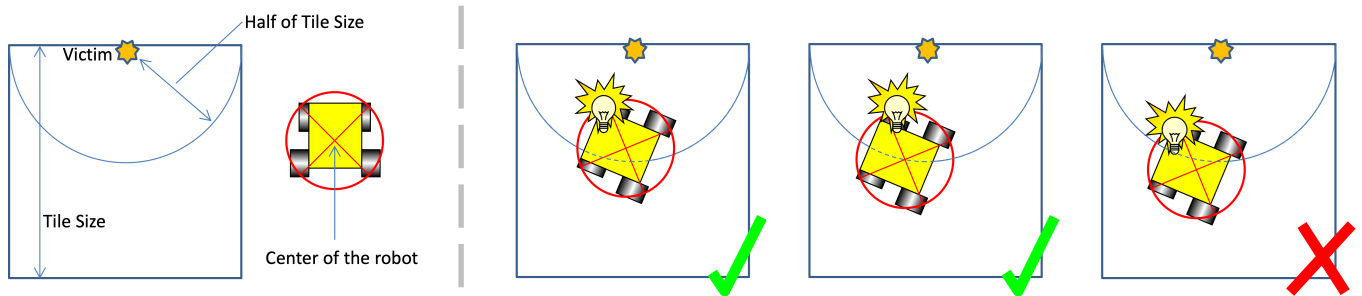

3. Victim identification (VI). Points are rewarded for each Successful Victim Identification on the field.
 - a. For victims and hazard maps located on a tile adjacent to a linear wall (even diagonally), i.e. all victims at the 6 tiles around a linear wall. : 10 points
 - i. Victims: 5 points
 - ii. Hazard maps: 10 points
 - b. On other walls (i.e.: floating walls) : 30 points
 - i. Victims: 15 points
 - ii. Hazard maps: 30 points

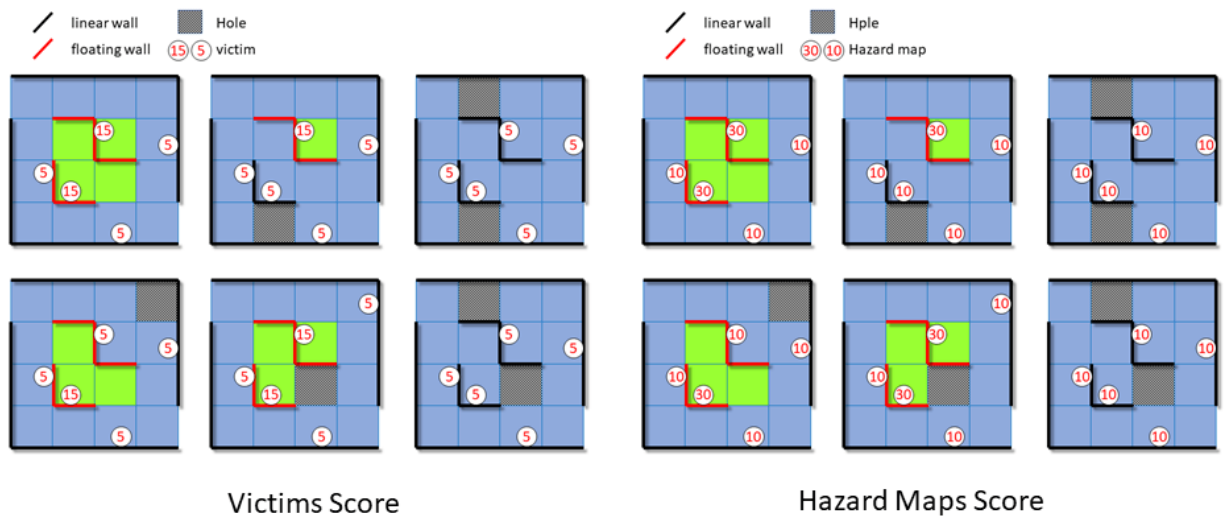

Some of the victims on the floating wall are worth 10 points. This is because 10 points victims are on a tile near a linear wall. The colour in the figure is for illustration only.

4. Victim type identification (VT). Additional 10 points are rewarded if the reported type of the victim and Hazard Map is correct.
 - a. Victims: 10 points
 - b. Hazard maps: 20 points

5. Victim misidentification (VMI). If a robot identifies the location of the victim to be greater than half the tile size away from the true position, it will be considered a misidentification and will cause 5 points deduction. However, the total points will never go below zero points.
6. Successful Checkpoint Negotiation (CN). A robot is awarded 10 points for each visited checkpoint. Refer to [4.4.5](#) for definition of visited tile.
7. Lack of progress (LoP). Each LoP will cause 5 points deduction. However, the total points will never go below zero points.
8. Area multipliers (AM). The scores for VI, VT, and CN obtained in each of the three areas will be multiplied by a unique multiplier. The multipliers are 1, 1.25, and 1.5 for areas 1, 2, and 3 respectively.
9. Successful Exit Bonus (EB). A robot will be awarded 10% of total score as an exit bonus if at least one victim has been identified, the robot returns to the starting tile, and sends an "exit" command to the game manager to finish the game.
10. Mapping bonus (MB). When the game ends, the robot may submit a comma-separated values (csv) file with the map of the maze encoded in a particular format (refer to the source code when made available). The mapping bonus is a multiplier between 1 and 2.
 - a. A csv file for each area must be submitted separately with the file name A1.csv, A2.csv, A3.csv.
 - b. Tiles and its edges and vertices are represented by a cell (value) in the csv file
 - c. For area 2 and 3, each quarter tile and its surrounding edges and vertices will be represented by a cell (value) in the csv file.
 - d. Walls are marked by '1'; holes as '2'; swamps as '3'; checkpoints as '4'; tiles with victim as '5'; starting tile as '6'; connection tiles from 1 to 2 as '7', 1 to 3 as '8', 2 to 3 as '9'; victims as the corresponding victim code, and any other tiles/edges/vertices should be zero.
 - e. For curved walls in area 3, the vertex should be represented by a '0'
 - f. The presence of a victim should be marked on the cell that represents the corresponding wall. If more than one victim is on a wall, the entry should be concatenated.
 - g. Maps can be stored in any rotation as long as it is a multiple of 90°
 - h. The correctness of a submitted map will be checked against the real map.
 - i. The starting tile or connection tiles will be used to align the two maps.
 - ii. For every non-zero entry on both the real and submitted map, the two values are compared.
 - iii. If the two values match, the correct count is incremented. Otherwise, incorrect count is incremented.
 - iv. The correctness is given by the ratio of the correct count over the sum of the correct count and incorrect count.
 - v. The correctness will be calculated separately for each area.
 - vi. The correctness for an area will be calculated for each possible orientation of the submitted map aligned on the real map. The maximum value will be used.
 - vii. The overall correctness will be an average of the correctness of each area + 1.

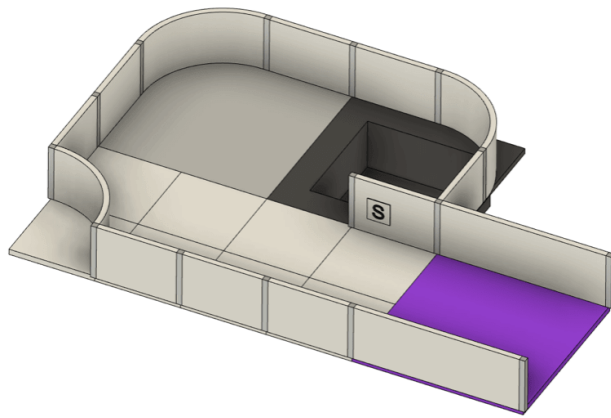

$$\begin{pmatrix} 0 & 1 & 1 & 1 & 1 & 1 & 1 & 1 & 0 & 0 & 0 & 0 & 0 \\ 1 & 4 & 0 & 4 & 0 & 2 & 0 & 2 & 1 & 0 & 0 & 0 & 0 \\ 1 & 0 & 0 & 0 & 0 & 0 & 0 & 0 & 1 & 0 & 0 & 0 & 0 \\ 1 & 4 & 0 & 4 & 0 & 2 & 0 & 2 & 1 & 0 & 0 & 0 & 0 \\ 1 & 0 & 0 & 0 & 0 & 0 & 1 & S & 1 & 1 & 1 & 1 & 1 \\ 1 & 0 & 0 & 0 & 0 & 0 & 0 & 0 & 0 & 8 & 0 & 8 & 0 \\ 1 & 1 & 0 & 0 & 0 & 0 & 0 & 0 & 0 & 0 & 0 & 0 & 0 \\ 0 & 0 & 1 & 0 & 0 & 0 & 0 & 0 & 0 & 8 & 0 & 8 & 0 \\ 0 & 0 & 1 & 1 & 1 & 1 & 1 & 1 & 1 & 1 & 1 & 1 & 1 \end{pmatrix}$$

11. Ties in scoring will be resolved based on the time each robot took to complete the game.
12. No duplicate rewards. For example, if a robot successfully visited a checkpoint multiple times, only one successful checkpoint negotiation will be rewarded. The same result applies to all other scoring rules.
13. Scoring will be automated through the platform scoring engine.

$$\text{Score} = \left(\sum_{\text{Area}} (\text{VI} + \text{VT} + \text{CN}) \cdot \text{AM} - \text{VMI} - \text{LoP} \right) \cdot \text{EB} \cdot \text{MB}$$

4.7. End of Play

1. A team may elect to stop the round early at any time. In this case, the team captain must indicate to the referee the team's desire to terminate the game. The team will be awarded all points earned up to the call for the end of the round.
2. The round ends when:
 - a. The time expires.
 - b. The robot sends an "exit" command to the game manager.

5. Open Technical Evaluation

5.1. Description

1. Your technical innovation will be evaluated during a dedicated time frame. All teams need to prepare for an open display during this time frame.
2. Judges will circulate and interact with the teams. The Open Technical Evaluation is intended to be a casual conversation with a "question and answer" atmosphere.
3. The main objective of the Open Technical Evaluation is to emphasize the ingenuity of innovation. Being innovative may mean technical advances as compared to the existing knowledge, or an out-of-the-ordinary, simple but clever, solution to existing tasks.

5.2. Evaluation Aspects

1. A standardized rubric system will be used focusing on:
 - creativity
 - cleverness
 - simplicity
 - functionality
2. Your “work” can include (but is not limited to) one of the following aspects:
 - creation of a new software algorithm to a solution
3. Teams must provide documents that explain their work. Each invention must be supported by concise but clear documentation. The documents must show precise steps towards the creation of the invention.
4. Documents must include one poster and one engineering journal. Teams should be prepared to explain their work.
5. Engineering journals which include development process and best practices must be submitted. More details about the mechanism to be used will be announced at the RoboCupJunior forum.
6. The poster should include name of team, country, league, programming language / libraries used, detail description of the algorithm you developed, time used for development and awards won by the team in its country, etc.

5.3. Sharing

1. Teams are encouraged to review other’s posters and presentations.
2. Teams awarded with certificates are required to post their documents and presentation online when asked by the OC/TC.

6. Conflict Resolution

6.1. Referee and Referee Assistant

1. During game play, the decisions made by the referee and/or the referee assistant are final.
2. (Not in 2021) At conclusion of game play, the referee will ask the captain to sign the score sheet. Captains will be given a maximum of 1 minute to review the score sheet and sign it. By signing the score sheet, the captain accepts the final score on behalf of the entire team. In case of further clarification, the team captain should write their comments on the score sheet and sign it.

6.2. Rule Clarification

1. If any rule clarification is needed, please contact the International RoboCupJunior Rescue Technical

Committee.

2. If necessary even during a tournament, a rule clarification may be made by members of the RoboCupJunior Rescue Technical Committee (TC) and Organizing Committee (OC).

6.3. Special Circumstances

1. If special circumstances, such as unforeseen problems or capabilities of a robot occur, rules may be modified by the RoboCupJunior Rescue Organizing Committee Chair in conjunction with available Technical Committee and Organizing Committee members, even during a tournament.
2. If any of the team captains/mentors do not show up to the team meetings to discuss the problems and the resulting rule modifications described at [6.3.1](#), it will be considered as an agreement.
3. In the event of unexpected issues, the OC will do its utmost to avoid any disadvantage to the team.